



Tech sheet

Protect data in transit

Securely, easily and traceably

www.pointsharp.com



Pointsharp makes email better

*Cryptshare, a part of the **Pointsharp Secure Information Exchange** solution, makes it easy for your staff to send encrypted email messages and attachments of any size at any time to internal and external recipients directly from your existing email system. There are no special software requirements for the recipients, no user accounts, no certificates or licences. Cryptshare makes it easy to communicate in complete privacy with everyone you need to, instantly, and at any time. Cryptshare makes your email suitable for the challenges of a modern business and will be adopted easily and quickly by your users.*

Benefits with Cryptshare

Every day, your company shares a wealth of data with customers, suppliers, and business partners, and email sits at the heart of these communications. However, email is not suitable for the large files we so often share, and it lacks security. So what happens when your data is confidential or large?

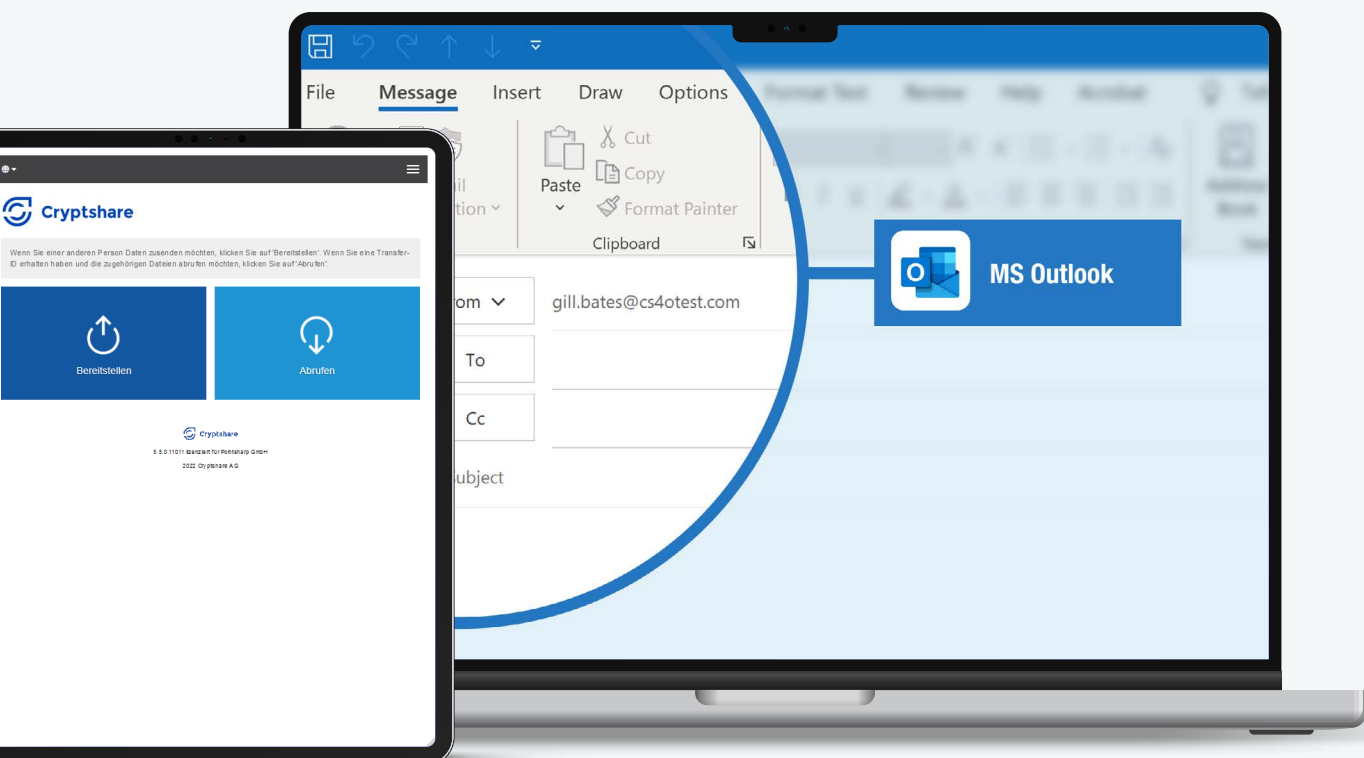
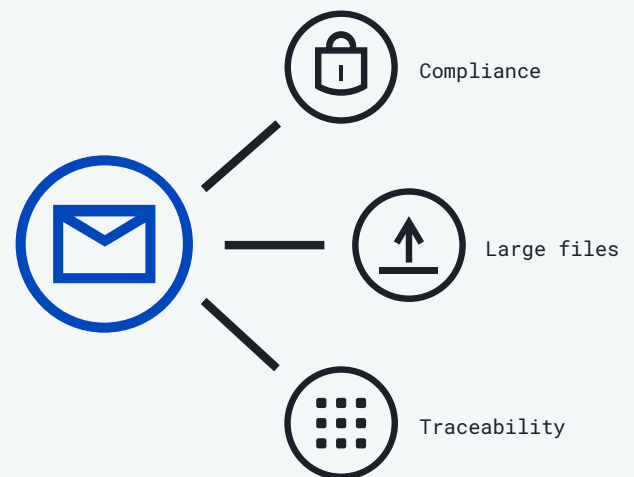

Fast and easy integration

Cryptshare offers several deployment options. Your server can be in-house, hosted, or in the cloud - whatever suits you best. In daily operation, it requires very little time and all email users in your domains have access unless you decide to exclude them by policy. There is fast and easy integration into your email system available - no matter whether you use Microsoft Outlook, OWA, or HCL Notes.



- On-Premises (VM / Appliance)
- Hosting Partner (VM)



- Public Cloud (SaaS)
- Private Cloud (Microsoft Azure)

Your company, your rules

Cryptshare can be made available to your team very quickly and the powerful policy engine allows you to tailor the system according to your needs. From the central admin interface, there are numerous options to implement your own rules, such as password options, maximum retention time, and much more. You will certainly want to let your communication partners know that you are taking greater care of shared information. For this, the user interface can be fully customized to your company brand, and notifications can be added.

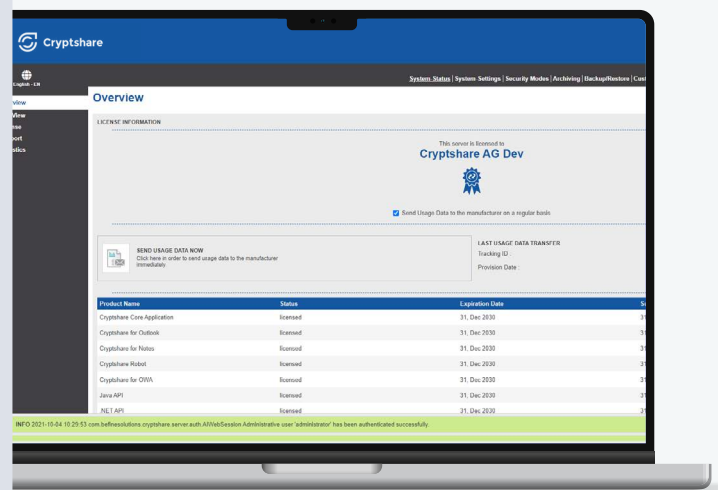

“Cryptshare convinced us due to its straightforward administration and it is easy to use the Outlook add-in.”

Dominik Scholl
ISO (RECARO Group)

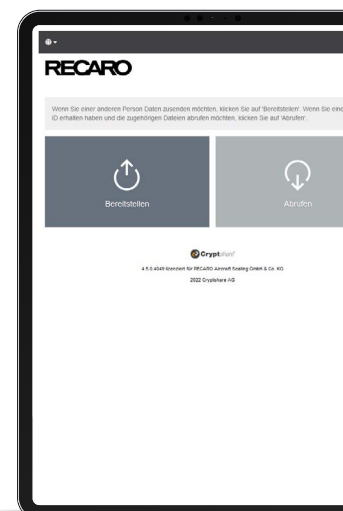

Email made better

Cryptshare is flexible with fast and easy integration to MS Outlook, OWA and HCL Notes or through open interfaces to a variety of applications and business processes. Cryptshare is used widely in many industries, from government to insurance, engineering to professional services, schools and hospitals, and from the entire enterprise to a single department.

Cryptshare in comparison

Requirement	S/MIME PGP	Your System?	Cryptshare
Email encryption	✓		✓
Sending files of any size			✓
Complete audit trail for all transfers			✓
No user management			✓
Usage without preparatory knowledge			✓
Usage out of MS Outlook	✓		✓
Usage out of HCL Notes	✓		✓
Archiving is possible	✓		✓
General ad-hoc availability			✓
Full control over data			✓
Easy to setup and configure			✓
Permanent secure connections in seconds			QUICK Technology

Pointsharp is a European cybersecurity company that enables organizations to secure authorizations, access, identities, and data in a user-friendly way. Security must be easy to use, and our vision is to give everyone access to a safe, modern digital workplace. We provide specialized IAM solutions that are made to fit the most demanding and specific needs.

We deliver European-made cybersecurity software and services to customers worldwide. You can often find our customers in large enterprises requiring extra high levels of security and regulatory demands, like the financial, governmental, industrial, and defense sectors.

We have our headquarters in Stockholm, Sweden, with offices in Germany, Denmark, Switzerland, and the Netherlands.

Pointsharp – security made easy

**Contact us for more
information, or a demo**

sales@pointsharp.com

